

ISTRUZIONI DI MONTAGGIO_pluris

INSTALLATION INSTRUCTION_pluris

1

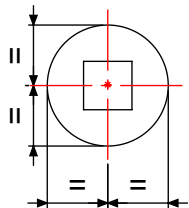

foro da eseguire nella porta rispettando la centratura con il quadro della serratura
hole to be drilled on the door respecting the centering with the latch square

2

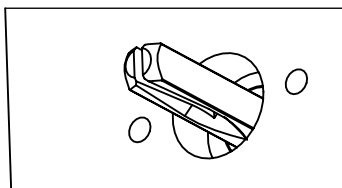

inserire il ferro quadro mantenendo la scanalatura verso il basso
place the square spindle through the lock with the groove facing down

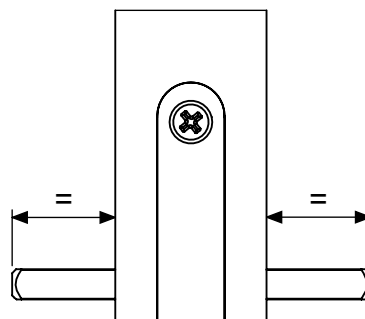

fare attenzione a mantenere la stessa distanza del ferro quadro da entrambi i lati della porta
pay attention to keep the same projection of the square spindle on both sides of the door leaf

4

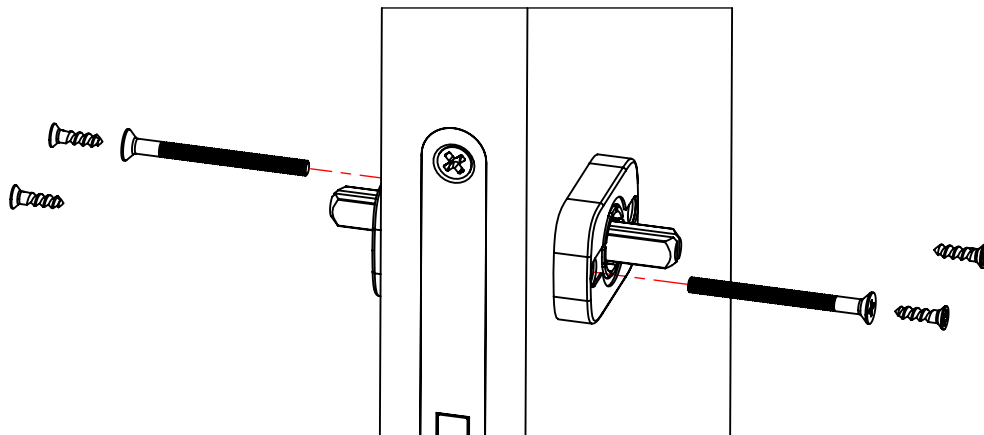

utilizzare le viti piu appropriate
use the appropriate screws

5

applicare le impugnature sul ferro quadro e fissarle utilizzando le viti grano tenendole ben in appoggio sulle rosette
slide both lever handles on the square spindle and fix them with the grub screw by keeping both of them firmly against the roses

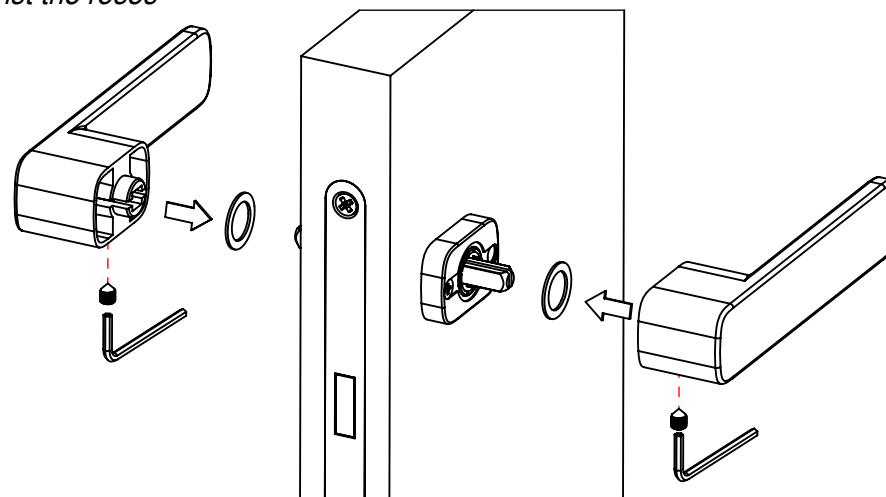

3

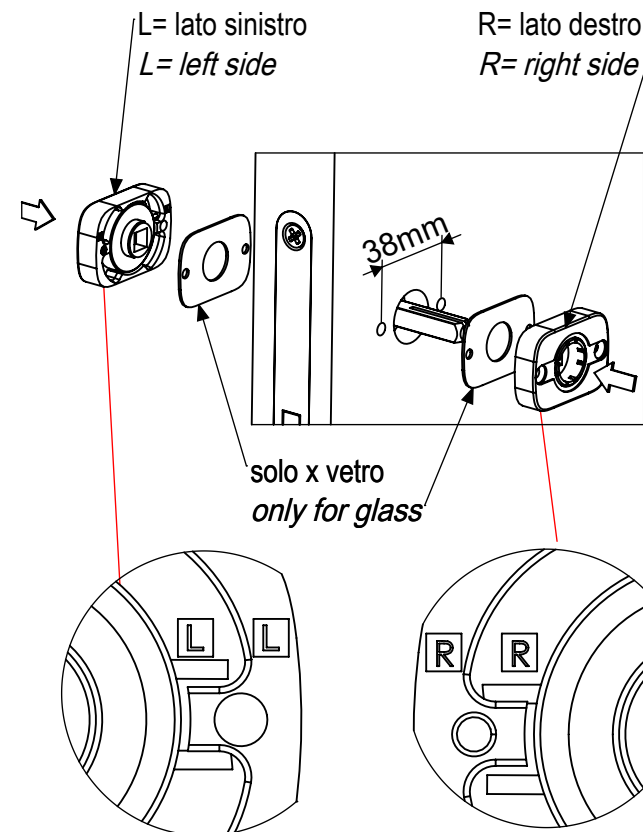

dnd

Dnd Martinelli S.r.l.
 Loc. Piani di Mura, 2
 25070 Casto (BS) Italia

t. +39 0365 899 113
 info@dndhandles.it
 www.dndhandles.it

ISTRUZIONI DI MONTAGGIO_pluris

INSTALLATION INSTRUCTION_pluris

CON BOCCHETTE WITH ESCUTCHEONS

fissare le sottobocchette in plastica alla porta con le viti e successivamente agganciare la bocchetta
apply the two plastic escutcheon with screw and then cover with metal escutcheons

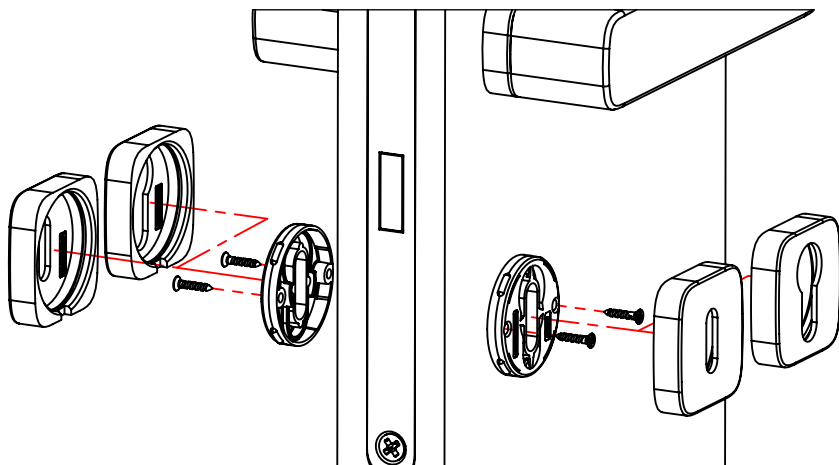

ESPLOSO COMPONENTI EXPLODED VIEW

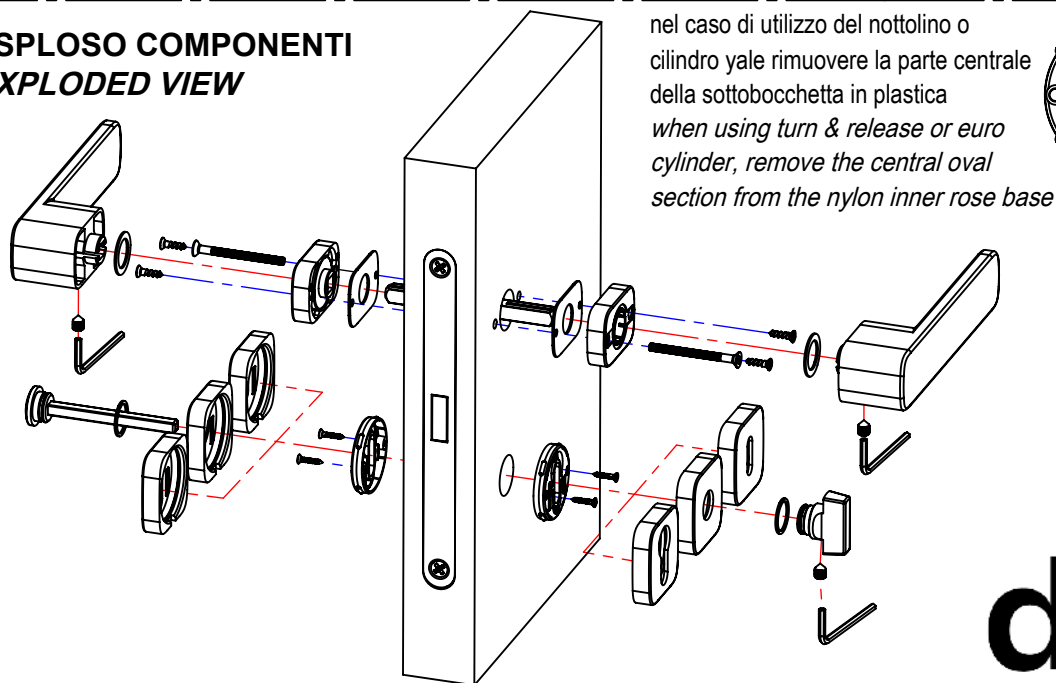

nel caso di utilizzo del nottolino o cilindro yale rimuovere la parte centrale della sottobocchetta in plastica
when using turn & release or euro cylinder, remove the central oval section from the nylon inner rose base



foro da eseguire nella porta rispettando la centratura con il quadro della serratura
hole to be drilled on the door respecting the centering with the square spindle

min Ø19mm
 max Ø21mm

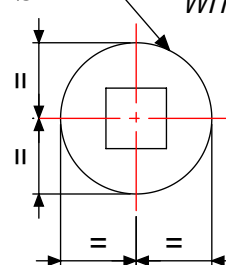

CON NOTTOLINO WITH TURN & RELEASE

inserire il nottolino nella serratura per centrare le bocchette con la serratura e successivamente bloccarle con le viti
insert the emergency release in the metal rose base and them through the lock to center it, and fix it with the screws

2

rimuovere il nottolino e agganciare le bocchette alle sottobocchette
remove the emergency release and apply the metal escutcheons

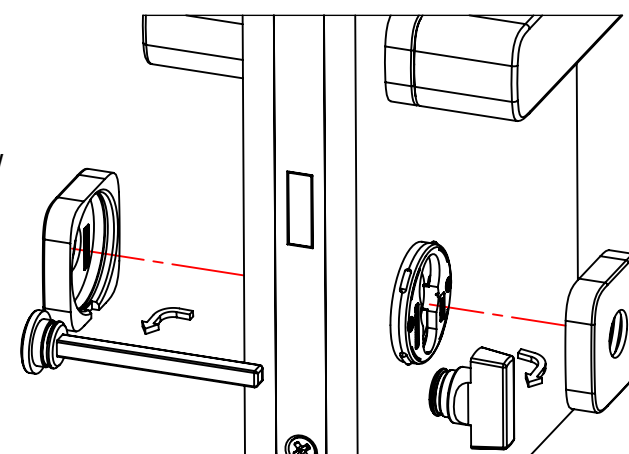
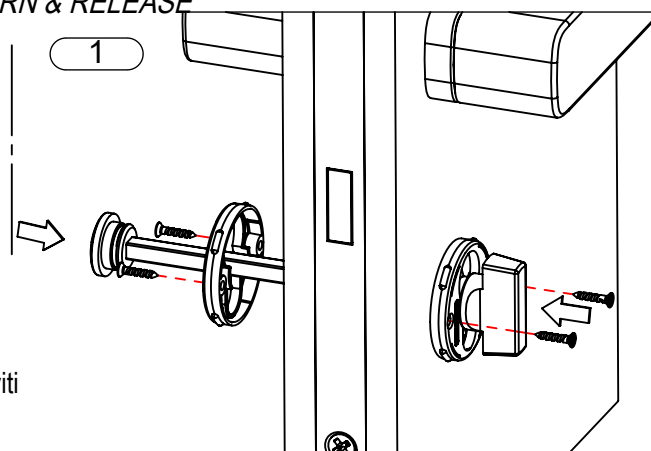

3

inserire il nottolino sulle bocchette e fissarlo con la vite grano
insert the emergency release and fix the snib with grub screw

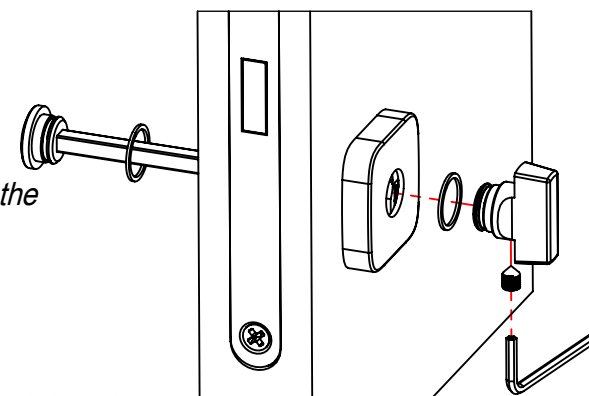

dnd

Dnd Martinelli S.r.l.
 Loc. Piani di Mura, 2
 25070 Casto (BS) Italia

t. +39 0365 899 113
 info@dndhandles.it
 www.dndhandles.it